

**Vehicles and prices  
2025**

**McRent**

**Your  
easy way  
out.**

# Vehicle overview



## Vans

The Vans are flexible, compact and perfect for a short trip up to four people. They have a kitchenette, but no bathroom with shower and toilet.



## Fully-integrated

Lots of space to recover from daily life and to relax with a larger living area what makes them perfect for a longer trip with up to four people.



## Campervan

In small space camper vans offer the same comfort as a motorhome. Models with a pop-up roof have space for up to four people.



## Overcabs

The classic motorhome design offers additional sleeping berths above the driver's cab and space for up to five people.



## Semi-integrated

Semi-Integrated vehicles are elegant and manoeuvrable, what makes them the ideal vehicle for a city trip for up to four travellers with or without a pull-down bed.

All of our motorhomes are fabricated by one of Europe's finest motorhome manufacturers and Erwin Hymer Group partners like Dethleffs, Sunlight, Crosscamp, Hymer, Bürstner, LMC and Etursco.

## ERWIN HYMER GROUP

# Vehicle group

## Urban

Our Urban Group is ideal for a short trip. The side and driving feeling of the campervan is similar to a van. Campervans are smaller than motorhomes but have a lot of storage space. The vehicles are perfect for active travellers who want to travel a lot at the holiday destination. Depending on the model, they offer space for two or four people.

### Standard e.G. Crosscamp\*



Perfect for a short break



Length/Width/Height	495 / 220 / 199 cm
Total perm. weight	2,75 t
Seats/Sleeping places	max. 4/4

### Luxury e.G. Dethleffs Globetrail 600er\*



The sporty one for four

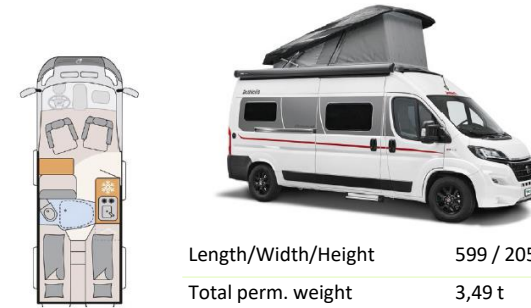

Length/Width/Height	599 / 205 / 289 cm
Total perm. weight	3,49 t
Seats/Sleeping places	max. 4/4

### Plus e.G. Sunlight Cliff 600\*



The compact vehicle for two



Length/Width/Height	599 / 205 / 273 cm
Total perm. weight	3,49 t
Seats/Sleeping places	max. 4/2

# Vehicle group

## Compact

Our Compact Group is ideal for your first holiday in a motorhome. The compact side of the semi-integrated or integrated vehicles makes them ideal for a city trip. The vehicles are manoeuvrable and can be easily manoeuvred through narrow alleys. Ideal for two people or in the case of the integrated motorhomes with a pull down bed above the driver's cap for up to four people.

### Plus e.G. Sunlight V66\*



Perfect for a city trip



Length/Width/Height	665 / 214 / 287 cm
Total perm. weight	3,49 t
Seats/Sleeping places	max. 4/2

### Luxury e.G. Dethleffs I6\*



Compact integrated vehicle

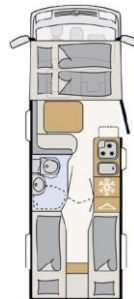

Length/Width/Height	695 / 220 / 281 cm
Total perm. weight	3,49 t
Seats/Sleeping places	max. 4/4

# Vehicle group

## Family

Our Family Group is ideal for families. The vehicles offer more space for cooking, playing or sleeping. The Family Standard group offers room for four people thanks to the pull-down bed above the seating group. The overcab models have room for up to five people with a sleeping area above the driver's cab and the conversion of the seating group. So the family holiday can start.

### Standard e.G. Dethleffs T7052 EB\*



Semi-integrated with four beds

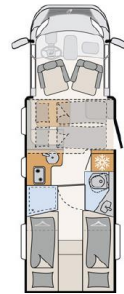

Length/Width/Height	741 / 233 / 294 cm
Total perm. weight	3,49 t
Seats/Sleeping places	max. 4/4

### Luxury e.G. Sunlight A70\*



Ideal for large families and groups



Length/Width/Height	725 / 232 / 314 cm
Total perm. weight	3,49 t
Seats/Sleeping places	max. 5/5

### Plus e.G. Sunlight A68\*



Perfect for the whole family



Length/Width/Height	659 / 232 / 314 cm
Total perm. weight	3,49 t
Seats/Sleeping places	max. 5/5

# Vehicle group

## Comfort

Our Comfort Group is more comfortable with luxury motorhomes. The greater sense of space makes the motorhomes ideal for longer journeys and stays with up to four seats and beds. They provide room to rest, relax and just enjoy your motorhome holidays. Integrated motorhomes offer a lot of space due to the integration of the driver's cabin.

### Standard e.G. Dethleffs T7055 EB\*



Chic, fast and roomy

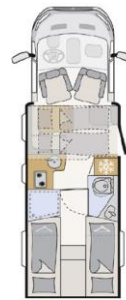

Length/Width/Height	736 / 233 / 299 cm
Total perm. weight	3,49 t
Seats/Sleeping places	max. 4/2

### Luxury e.G. Sunlight I69L\*



The comfortable fully-integrated



Length/Width/Height	741 / 232 / 290 cm
Total perm. weight	3,49 t
Seats/Sleeping places	max. 4/4

### Plus e.G. Dethleffs T7057\*



A lot of room for cosiness

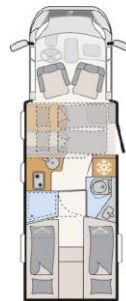

Length/Width/Height	741 / 233 / 300 cm
Total perm. weight	3,49 t
Seats/Sleeping places	max. 4/4

# Vehicle group

## Premium

Our Premium Group offers plenty of space to relax and a lounge area. The motorhomes are equipped with air-conditioning and satellite system on request. With around eight meters in length are the motorhome ideal for longer trips or if you want to stay at the same place. The overcabs modes are ideal for up to five people.

### Standard e.G. Dethleffs I7150-2 EB\*



Enjoy something special

Driving licence



Length/Width/Height	781 / 233 / 298 cm
Total perm. weight	4,25 t – 4,5 t
Seats/Sleeping places	max. 4/4

### Luxury e.G. Dethleffs I7850-2 EB\*



Luxury in perfection

Driving licence



Length/Width/Height	861 / 233 / 304 cm
Total perm. weight	5,0 t
Seats/Sleeping places	max. 4/4

### Plus e.G. Dethleffs XL A7872-2\*



Ideal for a long trip

Driving licence



Length/Width/Height	860 / 232 / 327 cm
Total perm. weight	5,0 t
Seats/Sleeping places	max. 5/5

# The rental fee

- ✔ Unlimited mileage\*
- ✔ Value Added Tax (VAT)
- ✔ Comprehensive coverage with a deductible of 1.500 € per loss
- ✔ Third-party liability insurance (details see Terms and Conditions)
- ✔ Vehicle manufacturer's mobility program and emergency service
- ✔ Awning\*\*
- ✔ Air conditioning in driver's cabin
- ✔ Bicycle rack (not suitable for E-bikes)
- ✔ Outside cleaning
- ✔ 2 gas bottles\*\* (1 full, 1 used)
- ✔ Balancing wedges
- ✔ CI cable
- ✔ Cable reel
- ✔ WC chemicals
- ✔ Water hose or watering can
- ✔ Saturday fee
- ✔ Dish set
- ✔ Safety package
- ✔ Service fee

\*Specials could have limited kilometres, they are separately marked. Extra kilometres will be charge according to the valid price list

\*\*Except group Urban Standard

Insurance, deposit and comprehensive/partial coverage with deductible vary in other countries



# Accessories

Accessories	Price	Description
Bicycle rack	0 €	per vehicle
Outside cleaning	0 €	per vehicle
Camping set	45 €	per rental
Dish Set	49 €	per rental
Bed set	59 €	per person
Towel set	25 €	per person
Child safety seat	29 €	per rental
Raised seat	16 €	per rental
Winter service	99 €	per rental
Snow chains	85 €	per rental
Inside cleaning	min. 139 €	per rental, if necessary
Emptying toilet	159 €	per rental, if necessary
Diesel / AdBlue	50 € + missing fuel	costs for diesel / AdBlue + refueling fee, if necessary
Amendment fee	20 €	per procedure
Processing fee (fines and penalties)	20 €	per procedure plus penalty
Hourly rate	29 €	for late drop-off of vehicle
Surcharge Saturday	72 €	per Saturday

\* Please note: Bicycle racks are not available for Premium Plus and Premium Luxury, as these vehicles have a large garage for storing bicycles.  
Winter tyres available from October - March and mandatory accessories from November - March.